

Color:   white

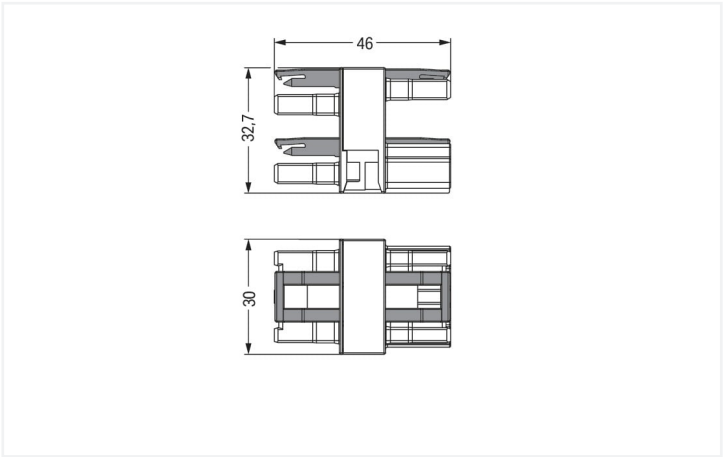

Dimensions in mm

Distribution connector WINSTA® MIDI with protection against mismating

The WINSTA® MIDI distribution connector A coding is the pluggable solution for your application in control cabinets, on PCBs or for lighting connections. Whether on PCBs, in control cabinets or for connecting lights – pluggable installation connectors from WAGO allow you to make connections according to various requirements in seconds. For greater security in electrical installations, the pluggable installation connector is equipped with mechanical protection against mismating. The pluggable installation connector is protected against ingress by solid objects in accordance with protection type IP20 (When mated: IP2xC (These compact connectors are not designed for use in open, easily accessible areas!)). The WINSTA® MIDI pluggable installation connector with A coding in white or black is usually used for general mains applications in power distribution. This pluggable installation connector is used for electrical currents up to 25 A. Thus the product is especially suitable for high power loads. The WINSTA® MIDI Pluggable Connection System with Push-in CAGE CLAMP® spring pressure connection technology facilitates precise electrification. Due to the included test slot, it is possible to check connections even when they are plugged in. That saves time and reduces installation labor and expense.

WINSTA® MIDI solutions for your electrical installation – protected against mismating and maintenance-free

The WINSTA® Pluggable Connection System allows pluggable electrical installation. This significantly reduces the need for servicing and lowers costs. Take advantage of the pluggable version of our maintenance-free spring pressure connection technology too! Plan your installation with with locking lever from WAGO.

- effective protection against mismating
- simple circuits
- with A coding for a large number of applications
- exact dimensions
- convenient installation and commissioning

Electrical data				
Ratings per		IEC/EN 60664-1		
Overvoltage category		III	III	II
Pollution degree		3	2	2
Nominal voltage		250 V	-	-
Rated surge voltage		4 kV	-	-
Rated current		25 A	-	-
Approvals per		UL 1977		
Rated voltage		600 V		
Rated current		23 A		
General information				
Note on contact resistance		approx. 1 mΩ of contact resistance approx. 0.25 mΩ contact transition plug/ socket		



Connection data		
Total number of potentials	3	Connection 1
PE function	Preceding PE contact	
		Pole number3
Physical data		
Pin spacing	10 mm / 0.394 inches	
Width	30 mm / 1.181 inches	
Height	32.7 mm / 1.287 inches	
Depth	46 mm / 1.811 inches	
Mechanical data		
Application	General mains applications	
Coding	A	
Marking	L N	
Potential marking	L N	
Mating force of a plug-in connection	Approx. 20 ... 70 N (depending on pole number)	
Retention force of a plug-in connection	When locked: > 80 N	
Unmating force of a plug-in connection	Unlocked: approx. 20 ... 70 N (depending on pole number)	
Number of mating cycles	200, without resistive load	
Type of distribution box	Distribution connector, 3-way	
Protection type	IP20; When mated: IP2xC (These compact connectors are not designed for use in open, easily accessible areas!)	
Plug-in connection		
Mismating protection	Yes	
Note on mismating protection	All WINSTA® components are 100% protected against mismating when: a.) plugging different numbers of poles b.) plugging while rotated 180 c.) plugging while laterally staggered d.) plugging one pole	
Locking lever	Yes	
Locking of plug-in connection	Locking lever	
Note on locking system	All connectors for mounted installations (snap-in versions for lighting fixtures or devices, all types of PCB and distribution connectors) are factory-equipped with locking levers to ensure plugs and sockets are securely locked. Additional locking levers are only required for flying leads (plug/socket).	
Number of locking levers	4	
Material data		
Note (material data)	Information on material specifications can be found here	
Color	white	
Insulation material	Polyamide (PA66)	
Flammability class per UL94	V0	
Contact material	Copper or copper alloy; surface-treated	
Contact plating	Tin	
Fire load	0.422 MJ	
Weight	25.5 g	





Environmental requirements	
Processing temperature	-5 ... +40 °C
Continuous operating temperature	-35 ... +85 °C
Note on continuous operating temperature	Insulating parts for temperatures ≤ 105 °C



Commercial data	
eCl@ss 10.0	27-44-06-03
eCl@ss 9.0	27-44-06-03
ETIM 8.0	EC002567
ETIM 7.0	EC002567
PU (SPU)	50 pcs
Packaging type	Box
Country of origin	DE
GTIN	4045454251512
Customs tariff number	85366990990

Environmental Product Compliance	
RoHS Compliance Status	Compliant, No Exemption

Approvals / Certificates

General approvals		Declarations of conformity and manufacturer's declarations	
  		Approval	Certificate Name
CCA DEKRA Certification B.V.	EN 61535	EU-Declaration of Confor- mity WAGO GmbH & Co. KG	-
CCA DEKRA Certification B.V.	IEC 61535		-
cURus Underwriters Laboratories Inc.	UL 1977		
cURus Underwriters Laboratories Inc.	UL 1059		

Approvals for marine applications

  	Approval	Standard	Certificate Name
ABS American Bureau of Ship- ping	-		19-HG1868589-PDA
DNV GL Det Norske Veritas, Ger- manischer Lloyd	-		TAE00001Z6
LR Lloyds Register	IEC 61984		LR22429487TA



Downloads

Environmental Product Compliance

Compliance Search			
Environmental Product Compliance 770-657			

Documentation

Bid Text			
770-657	19.02.2019	xml 2.72 KB	
770-657	12.03.2015	doc 23.00 KB	
ausschreiben.de 770-657			

CAD/CAE-Data

CAD data	
2D/3D Models 770-657	

CAE data	
EPLAN Data Portal 770-657	
WSCAD Universe 770-657	
ZUKEN Portal 770-657	

1 Compatible Products

1.1 System counterpart

1.1.1 Cable assembly



**Item No.: 771-9993/206-102**  
pre-assembled connecting cable; Eca;  
Plug/open-ended; 3-pole; Cod. A; H05VV-  
F 3G 1.5 mm²; 1 m; 1,50 mm²; white



**Item No.: 771-9993/106-102**  
pre-assembled connecting cable; Eca;  
Socket/open-ended; 3-pole; Cod. A;  
H05VV-F 3G 1.5 mm²; 1 m; 1,50 mm²;  
white



**Item No.: 771-9993/006-102**  
pre-assembled interconnecting cable;  
Eca; Socket/plug; 3-pole; Cod. A; H05VV-  
F 3G 1.5 mm²; 1 m; 1,50 mm²; white

1.1.2 Female connector/socket



**Item No.: 770-223**  
Socket; 3-pole; Cod. A; 4,00 mm²; white



**Item No.: 770-123**  
Socket; with strain relief housing; 3-pole;  
Cod. A; 4,00 mm²; white



**Item No.: 770-223/035-050**  
Socket; with strain relief housing; 3-pole;  
Cod. A; 4,00 mm²; white

1.1.3 Male connector/plug



**Item No.: 770-233**  
Plug; 3-pole; Cod. A; 4,00 mm²; white



**Item No.: 770-133**  
Plug; with strain relief housing; 3-pole; Cod. A; 4,00 mm²; white



**Item No.: 770-233/035-050**  
Plug; with strain relief housing; 3-pole; Cod. A; 4,00 mm²; white

1.2 Optional Accessories

1.2.1 Cover

1.2.1.1 Cover



**Item No.: 770-201**  
Lockout cap; 12-pole, separable; for sockets; Plastic; black



**Item No.: 770-221**  
Lockout cap; 12-pole, separable; for sockets; Plastic; white



**Item No.: 770-360**  
Lockout cap; for plugs; 5-pole; separable; yellow

1.2.2 Installation

1.2.2.1 Mounting accessories



**Item No.: 770-623**  
Mounting plate; 3-pole; for distribution connectors; Plastic; black



**Item No.: 770-673**  
Mounting plate; 3-pole; for distribution connectors; Plastic; white

Installation Notes

Installation

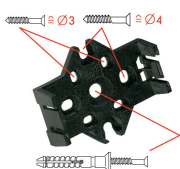

Mounting plates can be secured using commercially available screws or nail-drive anchors.



The distribution connectors snap together when attached to the mounting plate.



To release the distribution connector, unlock the latch using a screwdriver.

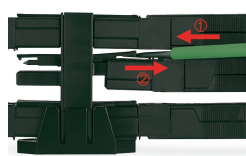

All distribution connector connections are locked and protected against accidental disconnection directly after mating. Locking of any connection is released using a screwdriver, even if all connections are used.